

450,000 SF | SIX-BUILDING PARK
44,871 SF AVAILABLE

AXIS

PARK NORTH

101 BILLERICA AVE.

NEWMARK

Camber
DEVELOPMENT

WHEELOCK
STREET CAPITAL

BUILDING 3

16,571 SF
AVAILABLE

BUILDING SPECS

- YEAR BUILT: 2000
- LOADING: 2
- PARKING: 3.3/1000
- POWER: 3,000 AMPS 277/480V
3 PHASE, 4 WIRE
- HVAC: FULLY CONDITIONED
- CEILING HEIGHTS: 18'
- ROOF: TPO 2023
- UTILITIES
 - ELECTRIC
 - GAS
 - WATER/SEWER

SINGLE STORY R&D



FIRST FLOOR

16,571 SF

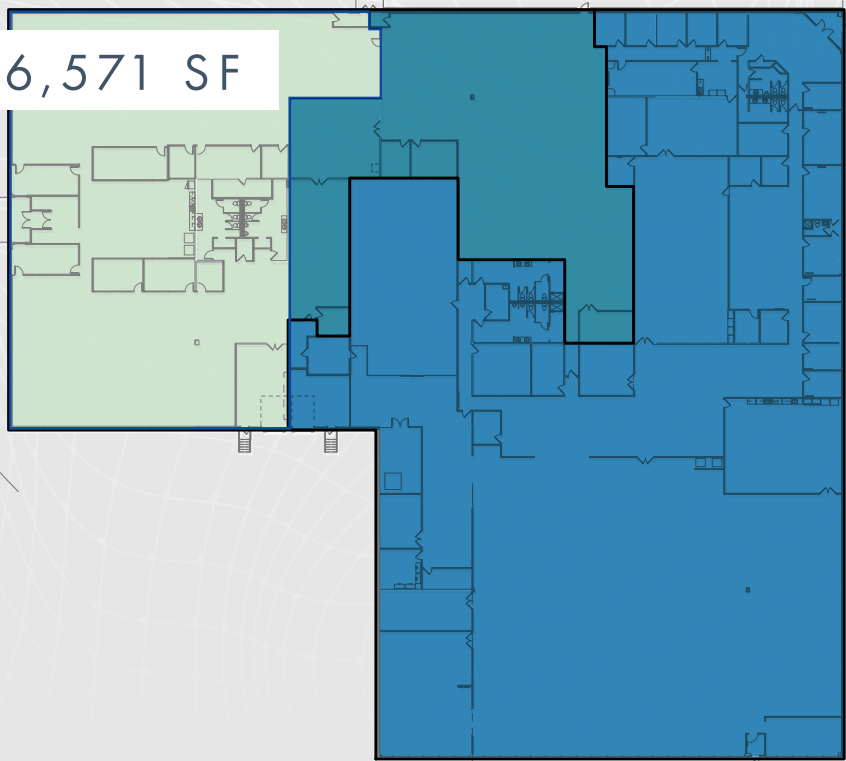

- AVAILABLE NOW
- LEASED

BUILDING 5

28,300 SF
AVAILABLE

BUILDING SPECS

- YEAR BUILT: 1987
- LOADING: 2
- LOBBY: 2-LEVEL
- PARKING: 3.3/1000
- POWER: 2,400 AMPS 277/
480 VOLTS, 3 PHASE,
4 WIRE
- HVAC: FULLY CONDITIONED
- CEILING HEIGHTS: 11'
- ROOF: RUBBER MEMBRANE 2011
- UTILITIES
 - ELECTRIC
 - GAS
 - WATER/SEWER

2-LEVEL R&D/OFFICE



SECOND FLOOR

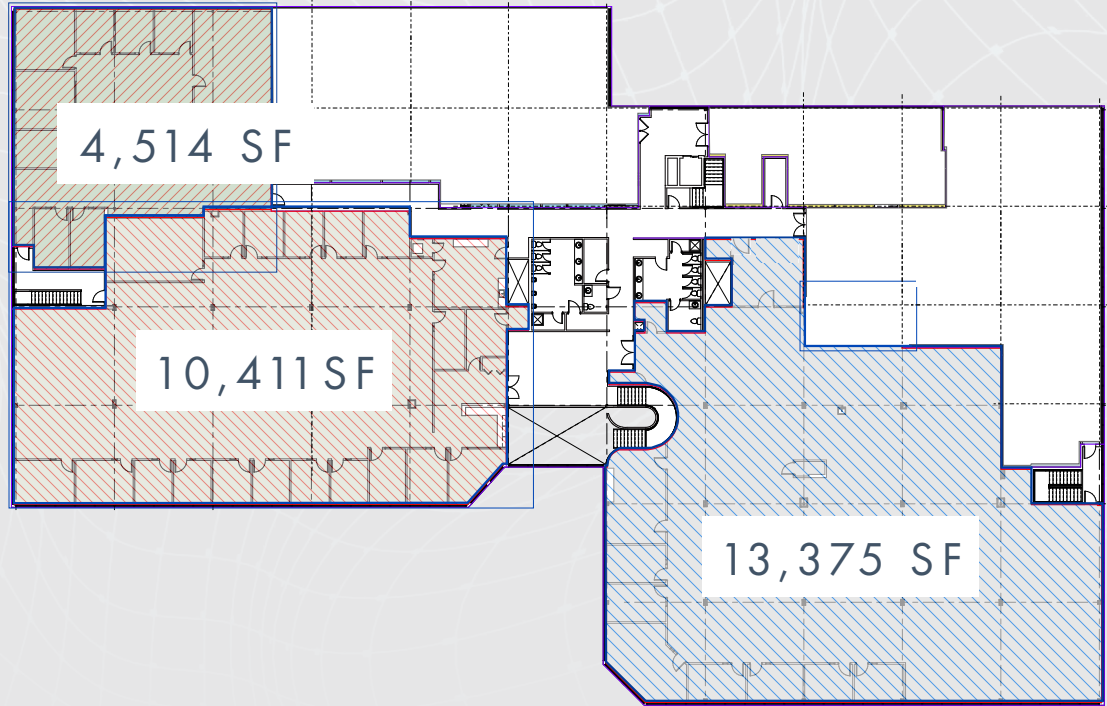

AXIS

PARK NORTH

- CAMPUS SETTING WITH GROWTH POTENTIAL
- CONVENIENT LOCATION
- ROBUST PHYSICAL INFRASTRUCTURE

450,000 SF flex/R&D/office offering a range of space options for growing companies. The six building, master-planned, 38-acre campus was developed in stages from 1985 to 2001.

The park's buildings serve as home to headquarters, and incubator spaces for leading medical device manufacturing, bio-technology, clean-technology, R&D and robotics companies.

Numerous Nearby Amenities

Conveniently located, the park offers numerous amenities including several restaurants, day care facilities, hotels and fitness centers. Downtown Boston and Logan International Airport are less than 45 minutes away.

Nearby Talent

The park sits only minutes away from some of the most successful and influential companies in the life science, medical device, bio-tech and clean-tech industries.

BUILDING 3

62,276 SF Total
16,571 SF Available

BUILDING 5

80,305 SF Total
28,300 SF Available

NEARBY TALENT





COMMUTER ACCESS

AXIS
PARK NORTH

BOSTON 25 MILES

AXIS
PARK NORTH
101 BILLERICA AVE.

Camber 
DEVELOPMENT

WHELOCK
STREET CAPITAL

NEWMARK

MATT ADAMS

617.863.8583
matt.adams@nmrk.com

TORIN TAYLOR

617.863.8587
torin.taylor@nmrk.com

RICH RUGGIERO

617.863.8550
richard.ruggiero@nmrk.com

RORY WALSH

617.863.8584
rory.walsh@nmrk.com